

1 2 3 4 5 6 7 8 9

A

B

C

D

E

F

G

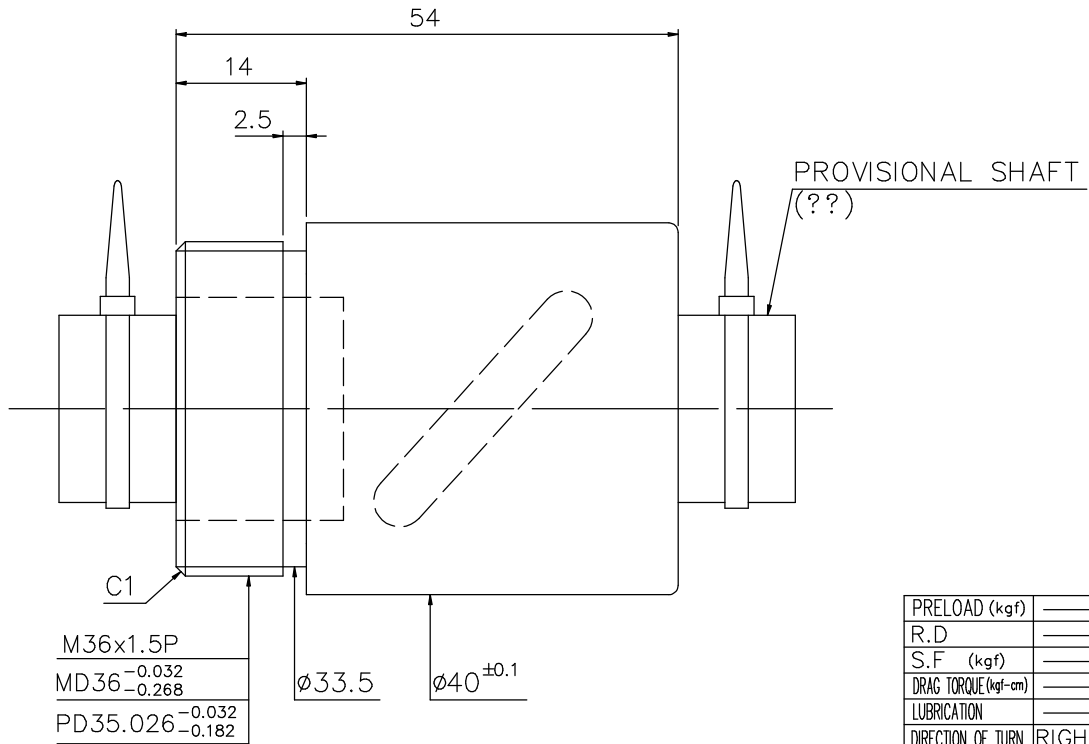
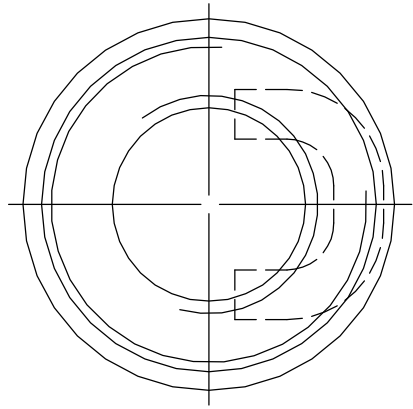

M36x1.5P
MD36 ^{-0.032} _{-0.268}
PD35.026 ^{-0.032} _{-0.182}

PRELOAD (kgf)	_____
R.D	_____
S.F (kgf)	_____
DRAG TORQUE (kgf-cm)	_____
LUBRICATION	_____
DIRECTION OF TURN	RIGHT
PC DIA.	20.2
BALL DIA.	3.175
BALL TRACK FORM	GOTHIC
BACKLASH	
CIRCUIT	3.5*1
LEAD ANGLE	4.51°
DYNAMIC (kgf)	_____
STATIC (kgf)	_____
LEAD	5.

SPEC: R20-5C1-RSB

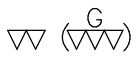

THREAD LENGTH	UNCHAMFERED USE <input type="checkbox"/> CO.5 <input checked="" type="checkbox"/> R1 <input type="checkbox"/> C	CUSTR	DATE
$\begin{matrix} + \\ 0 \\ - \end{matrix}$	ROUGH M/C FIN M/C GRD	SCALE	DWG
$\begin{matrix} + \\ 0 \\ - \end{matrix}$	25° 6.3° 0.4g	1: X	???
$\begin{matrix} + \\ 0 \\ - \end{matrix}$	UNTOL DIMN mm	TITLE	CHK
$\begin{matrix} + \\ 0 \\ - \end{matrix}$	UP 6 30 120 300 600 1200 2400 OVER	BALL SCREW	APPD
$\begin{matrix} + \\ 0 \\ - \end{matrix}$	TO 6 30 120 300 600 1200 2400 2400	SNCM220	
T: --- e300: ---	±0.1 ±0.2 ±0.3 ±0.4 ±0.5 ±0.8 ±1.0 ±1.5	MATAL	PROCESS NO.
E: --- e: ---	THREAD BALL TRACK HRC 58 ~ 62	DWG.NO. A10CL6A1	E
	⊕ THREAD END ALLOWS ABOVE LENGTH OUT OF HARDNESS TOLERANCE		

CUSTOMER DRAWING NO.	721-002
MC TYPE	96-009
ANAL TYPE	X

DATE	MODIFICATION	APPROVED

* PLEASE IGNORE CHINESE CHARACTERS WHICH ARE FOR OUR REFERENCE ONLY.

HIWIN® BALLSCREWS