

A
B
C
D
E
F
G

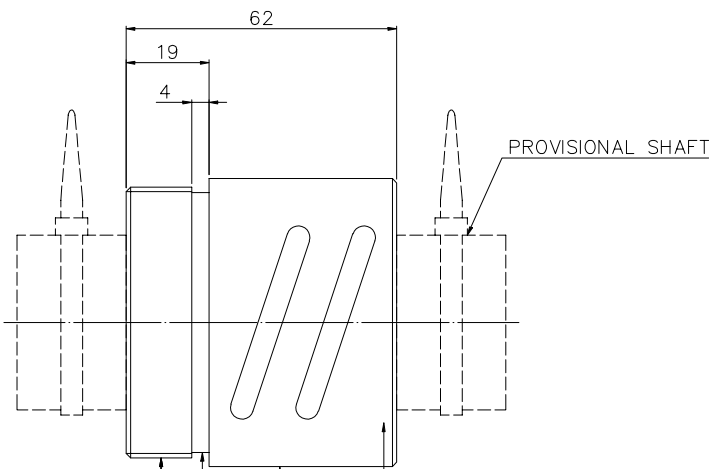
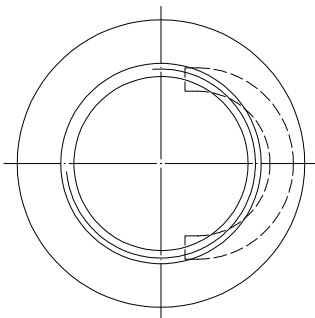

M62X2P
 MD62 $\begin{matrix} -0.038 \\ -0.318 \end{matrix}$
 PD60.701 $\begin{matrix} -0.038 \\ -0.218 \end{matrix}$

PRELOAD(kgf)	~
R.D	~
S.F (kgf)	~
DRAG TORQUE(kgf-cm)	~
DIRECTION OF TURN	R
PC DIA.	40.03
BALL DIA.	3.175
BACKLASH	Δ
CIRCUIT	2.5*2
LEAD ANGLE	2.28
DYNAMIC (kgf)	1859
STATIC (kgf)	6354
LEAD	5

SPEC: R40-5B2-RSB

MAX. AXIAL LOAD (kgf)	LUBRICATION	SPACE BALL
MAX. ROTATIONAL SPEED (rpm)	EI TYPE ASSEMBLY METHOD	CUSTOMER DRAWING NO.
DN VALUE	CUSTOMER MC TYPE	CUSTOMER AXIAL TYPE
MAX. FEED RATE (m/min)		
ACCELERATION (m/sec ²)		
SUPPORT METHOD		

	UNCHAMFERED USE <input type="checkbox"/> R0.5 <input checked="" type="checkbox"/> R1 <input type="checkbox"/> R ROUGH W/C FIN W/C GRD ∇ $\nabla \nabla$ $\nabla \nabla \nabla$ SCALE 1: X UNTOL DIMN mm UP 6 30 120 300 600 1200 2400 2400 ± 0.1 ± 0.2 ± 0.3 ± 0.4 ± 0.5 ± 0.8 ± 1.0 ± 1.5	MATA SH: ROLLED DATE 2007.08.27 NT: SNCM220/SCM415 DWG KAI THREAD BALL TRACK APPD Lady HRC 56 ~ 62 PROCESS NO. G
*BREAK SHARP EDGE UNLESS OTHER SPECIFIED. *未畫倒角者以R0.5MAX ● THREAD END ALLOWS ABOVE LENGTH OUT OF HARDNESS TOLERANCE	CUSTR HIWIN BALLSCREWS	DWG.NO. A115NDA4

08.27.07	MOD.	Lady
DATE	MODIFICATION	APPROVED

* PLEASE IGNORE CHINESE CHARACTERS WHICH ARE FOR OUR REFERENCE ONLY.