

A10EN7A1

Released by HIWIN design group.

▽ (▽▽)

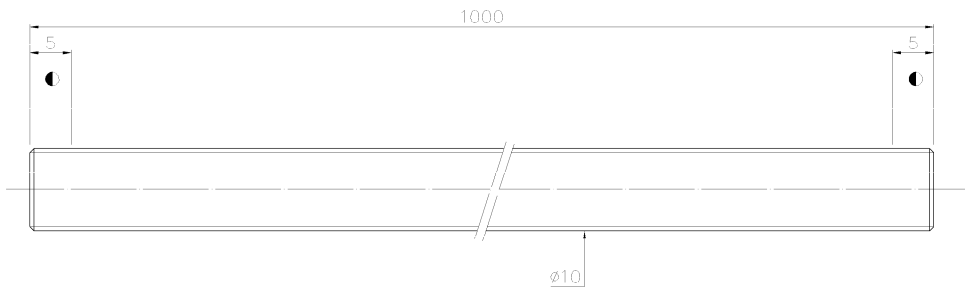

FRELOAD(kgf)	~
R/D	7.742
S.F (kgf)	~
TRAC TORQUE(kgf-cm)	~
DIRECTION OF TURN	R
PC DIA.	10.2
BALL DIA.	2.381
BACKLASH	~
CRODII	~
LEAD ANGLE	7.12
DYNAMIC (kgf)	~
STATIC (kgf)	~
LEAD/PITCH	4

SPEC: R10-4-1000-1000-0.05

MAX. AXIAL LOAD(kgf)	LUBRICATION		
MAX. ROTATIONAL SPEED (rpm)	SPACE BALL		
MIN. VALUE	LT TYPE (SUS/ONLY IN RHO)		
MAX. FEED RATE (m/min)	CUSTOMER DRAWING NO.		
ACCELERATION (m/sec ²)	CUSTOMER MC TYPE		
SUPPORT METHOD	CUSTOMER AXIAL TYPE		

UNHAMPERS USE	<input type="checkbox"/> R0.5	<input checked="" type="checkbox"/> R1	<input type="checkbox"/> R	SCALE		MATERIAL	SH. CF53	DATE	2007.01.02
ROUGH MACHINING	0.05	0.02	0.01	SCALE	1.X			DWG	Michelle
UNTIL CHAIN mm						THREAD	BALL TRACK	APPD	SIGMA
0.1	0.2	0.3	0.4	0.5	0.8	HRC	56 ~ 62	CUSTR	HIWIN
								DWG NO	A10EN7A1

* BREAK SHARP EDGE IN THIS OTHER SPECIFIED
* 未畫倒角者以 R0.5 MAX

● THREAD END ALLOWS ABOVE LENGTH
EXIT OF HARDNESS TOLERANCE

DATE	MODIFICATION	APPROVED

* PLEASE IGNORE CHINESE CHARACTERS WHICH ARE FOR OUR REFERENCE ONLY.