

A10JSJA1

693.42

(125.22)

15

527.56

58

15

40.64

3.3

27.94

81.28

12.7

6

OIL HOLE

D

10

12

0.022 BB'

0.016 BB'

0.004 C'

0.016 AA'

0.008 C'

19.05

3.099W

19.05

1.5

φ32

A

φ42.8⁰_{-0.1}

WIPER BOTH ENDS

φ29.2

φ26.162

φ20^{-0.007}_{-0.015}

φ15.875^{-0.013}_{-0.020}

6.1^{+0.25}

1/2"-20UNF

MD 12.667

MD 12.461

PD 11.841

PD 11.732

φ42.85⁰_{-0.025}

φ73

60.5

28.5 MAX

φ4 THRU

37.6 MAX

30°

2-φ10.5 THRU

BCD58.5

D-D VIEW

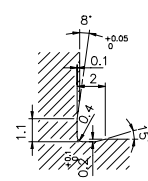

F0.4X0.2DIN509

X DETAIL

- 1. MAX AXIAL LOAD: _____ kgf
- 2. MAX BALLSCREW ROTATIONAL SPEED: _____ rpm
- DN VALUE: _____
- ACCELERATION = _____ m/sec²
- 3. MAX FEED RATE: _____ m/min

SPEC: L32-5.08B2-FSV-527.56-693.42-0.012

UNC/UNF USE	RO.5	R1	R
ROUGH/FAIN. M/Z/L	CRD	SCALE	1: X
UNTOL DIMN	mm		
UP	6	30	120
TO	6	30	120
	±0.1	±0.2	±0.3
	±0.3	±0.4	±0.5
	±0.8	±1.0	±1.5

T: -0.016 e300: 0.012

E: 0.016 e: 0.014

UNC/UNF USE	RO.5	R1	R
ROUGH/FAIN. M/Z/L	CRD	SCALE	1: X
UNTOL DIMN	mm		
UP	6	30	120
TO	6	30	120
	±0.1	±0.2	±0.3
	±0.3	±0.4	±0.5
	±0.8	±1.0	±1.5

HIWIN® BALLSCREWS

PRELOAD (kgf)	207
R.D	29.324
S.F (kgf)	0.65~1.92
DRAG TORQUE (kg-cm)	1.88~5.64
LUBRICATION	
DIRECTION OF TURN	L.H
PC DIA.	32.6
BALL DIA.	3.175
BACKLASH	0
CIRCUIT	2.5*2
LEAD ANGLE	2.84°
DYNAMIC (kgf)	1886
STATIC (kgf)	5666
LEAD	5.08

MATERIAL	SH: 50CrMo4	DATE	11.29.01
NT: SNCM220	DWG	58	
THREAD BALL TRACK	HRC 58 ~ 62	PROCESS NO.	G I E

CUSTR HIWIN STD.
DWG.NO. A10JSJA1

DATE	MODIFICATION	APPROVED

* PLEASE IGNORE CHINESE CHARACTERS WHICH ARE FOR OUR REFERENCE ONLY.

*BREAK SHARP EDGE UNLESS OTHER SPECIFIED	CUSTOMER DRAWING NO.
*未量倒角者以R0.5MAX	
THREAD END ALLOWS ABOVE LENGTH	MC TYPE
OUT OF HARDNESS TOLERANCE	ANAL TYPE