

Shaft diameter $\varnothing d \leq 30$

Shaft diameter $\varnothing d \geq 35$

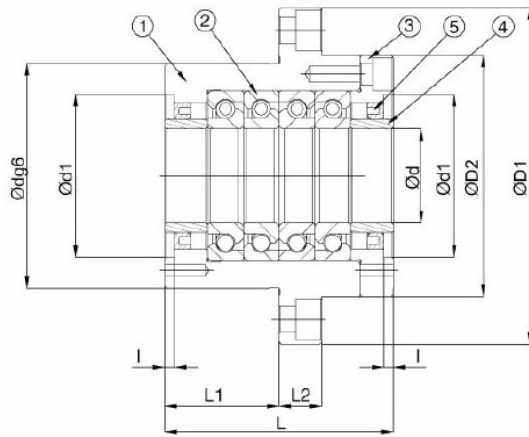

DFF

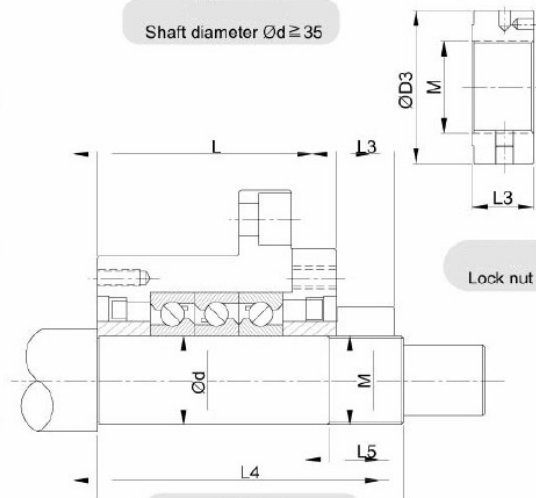

Lock nut

Dimensions of shaft end

Unit : mm

Model No.	Basic dynamic load rating C _e (kgf)	Permissible axial load (kgf)	Preload (kgf)	Axial rigidity (kgf/μm)	Starting torque (kgf-cm)	Lock nut			Dimensions of shaft end		
						M	D3	L3	Weight Kgs	d	L4
WBK 17DF_M	2240	2710	220	75	1.5	M17X1	37	18	1.9	69	
WBK 17DF									1.2	81	23
WBK 17DFF_M	3620	5420	440	145	2.8				2.3	101	
WBK 20DF_M	2240	2710	220	75	1.5	M20X1	40	18	1.9	69	
WBK 20DF									1.2	81	23
WBK 20DFF_M	3620	5420	440	145	2.8				2.3	101	
WBK 25DF	2910	4150	320	100	2.5				3.1	89	
WBK 25DFD	4700	8300	440	150	3	M25X1.5	45	20	3.4	25	104
WBK 25DFF	4700	8300	640	200	4.6						119
WBK 30DF	2980	4400	340	105	2.5	M30X1.5	50	20	3.0	30	89
WBK 30DFD	4850	8800	460	155	3.5						104
WBK 30DFF	4850	8800	680	205	4.6				3.3	119	26
WBK 35DF	3150	5100	390	120	3	M35X1.5	55	22	3.4	35	92
WBK 35DFD	5150	10200	530	175	4						107
WBK 35DFF	5150	10200	780	240	5.5				4.3	121	30
WBK 40DF	3250	5300	400	125	3	M40X1.5	60	22	3.6	40	92
WBK 40DFD	5250	10600	540	185	4						107
WBK 40DFF	5250	10600	800	245	5.5				4.2	121	30