

1
A10B7SA1

2 Released by HIWIN design group.

3
4
5
6
7
8
9
▽ (▽▽)

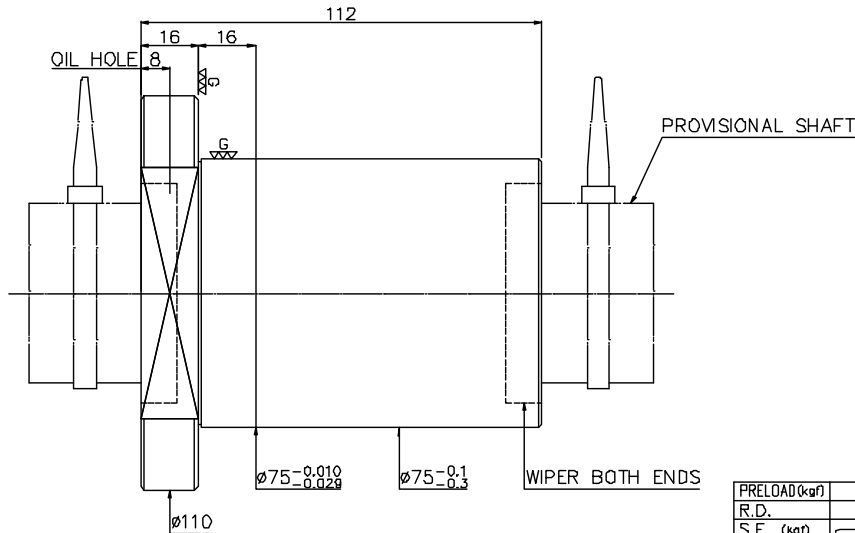
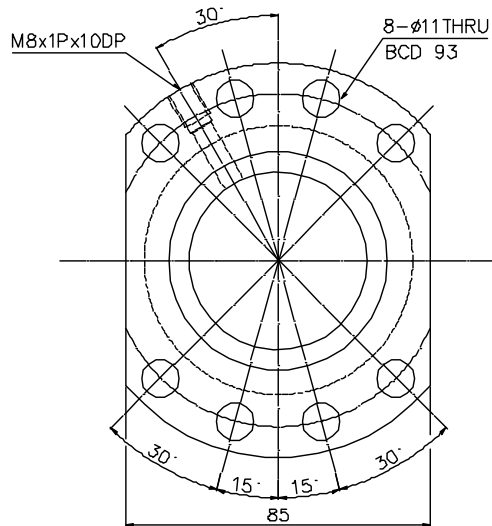

PRELOAD (kgf)	~
R.D.	~
S.F. (kgf)	~
DRAG TORQUE (kgf-m)	~
DIRECTION OF TURN	R
P.C. DIA.	51.93
BALL DIA.	6.35
BACKLASH	0.15 MAX
CIRCUIT	6
LEAD ANGLE	3.51
DYNAMIC (kgf)	5526
STATIC (kgf)	16668
LEAD	10

SPEC:R50-10T6-FSI

MAX. AXIAL LOAD (kgf)	LUBRICATION	BALL DIA.
MAX. ROTATIONAL SPEED (rpm)	SPACE BALL	BACKLASH
DN VALUE	B TYPE ASSEMBY METHOD	CIRCUIT
MAX. FEED RATE (m/min)	CUSTOMER DRAWING N/L	LEAD ANGLE
ACCELERATION (m/sec ²)	CUSTOMER I/MC TYPE	DYNAMIC (kgf)
SUPPORT METHOD	CUSTOMER ANAL. TYPE	STATIC (kgf)
		LEAD

MEAN LENGTH

UNCHAMFERED USE R0.5 R1 OR SCALE

ROUGH N/C FIN N/C GFD GFD SCALE

1:1 1:X

NORMAL TOLERANCE mm

10	16	30	50	120	200	300	500	1000	1500	2000	OVER
± 0.1	± 0.2	± 0.3	± 0.4	± 0.5	± 0.8	± 1.0	± 1.5				

THREAD BALL TRACK HRC 56 ~ 62

CUSTR HWN STD

DATE 2008.03.24

DWG Penny

APPD Michelle

PROCESS NL G

DWG.NO. A10B7SA1

*PERK SHARP EDGE UNLESS OTHER SPECIFIED

*未量銳角者以R0.5MAX

HEAD END ALLOWS ABOVE LENGTH OUT OF HARDNESS TOLERANCE

DATE	MODIFICATION	APPROVED

* PLEASE IGNORE CHINESE CHARACTERS WHICH ARE FOR OUR REFERENCE ONLY.