

515.62

A  
B  
C  
D  
E  
F  
G

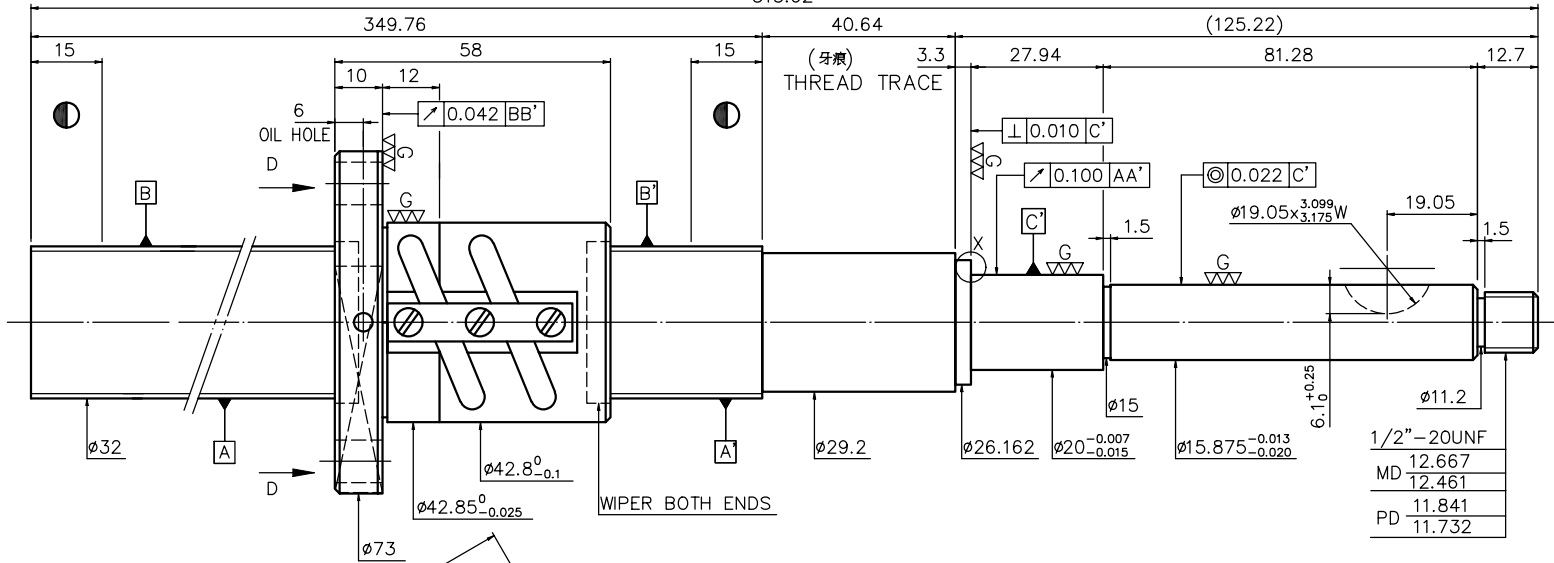

1/2"-20UNF
MD 12.667
12.461
PD 11.841
11.732

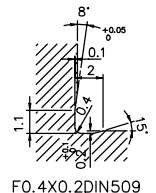
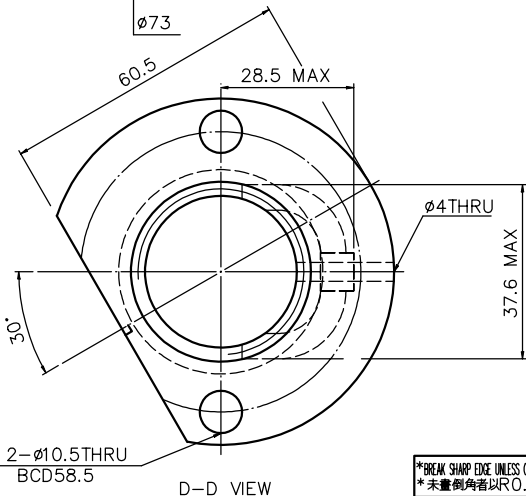

- 1. MAX AXIAL LOAD: \_\_\_\_\_ kgf
- 2. MAX BALLSCREW ROTATIONAL SPEED: \_\_\_\_\_ rpm
- DN VALUE: \_\_\_\_\_
- ACCELERATION = \_\_\_\_\_ m/sec<sup>2</sup>
- 3. MAX FEED RATE: \_\_\_\_\_ m/min

PRELOAD(kgf)	113
R. D	29.124
S.F (kgf)	0.04~1.36
DRAG TORQUE(NF-cm)	0.10~4.00
LUBRICATION	
DIRECTION OF TURN	L. H
PC DIA.	32.4
BALL DIA.	3.175
BACKLASH	0
CIRCUIT	2.5*2
LEAD ANGLE	2.86°
DYNAMIC (kgf)	1702
STATIC (kgf)	5098
LEAD	5.08

SPEC: L32-5.08B2-FSV-349.76-515.62-0.05

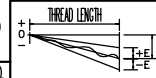
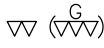

UNCHAMFERED USE	<input type="checkbox"/> R0.5	<input type="checkbox"/> R1	<input type="checkbox"/> R	SCALE			
ROUGH W/CHEN M/C	<input type="checkbox"/> GFD	<input type="checkbox"/> GFD	<input type="checkbox"/> GFD	1: X			
UNTO	6	30	120	500	600	1200	OTHER
TO	±0.1	±0.2	±0.3	±0.4	±0.5	±0.8	±1.0 ±1.5

MATL	SH: CF53	DATE	11.29.01
THREAD BALL TRACK	INT: SNCM220	DWG	球絲螺絲
HRC	56 ~ 62	APPD	陳榮輝
CUSTR	HIWIN STD.	PROCESS NO	G I E
DWG. NO.	A10JSBA1		

*BREAK SHARP EDGE (UNLESS OTHER SPECIFIED)	CUSTOMER DRAWING NO.
*未畫倒角者以R0.5MAX	
THREAD END ALLOWS ABOVE LENGTH	MC TYPE
OUT OF HARDNESS TOLERANCE	AXIAL TYPE

E 300: 0.05



DATE	MODIFICATION	APPROVED

\* PLEASE IGNORE CHINESE CHARACTERS WHICH ARE FOR OUR REFERENCE ONLY.