

# A10JSDA1

693.42

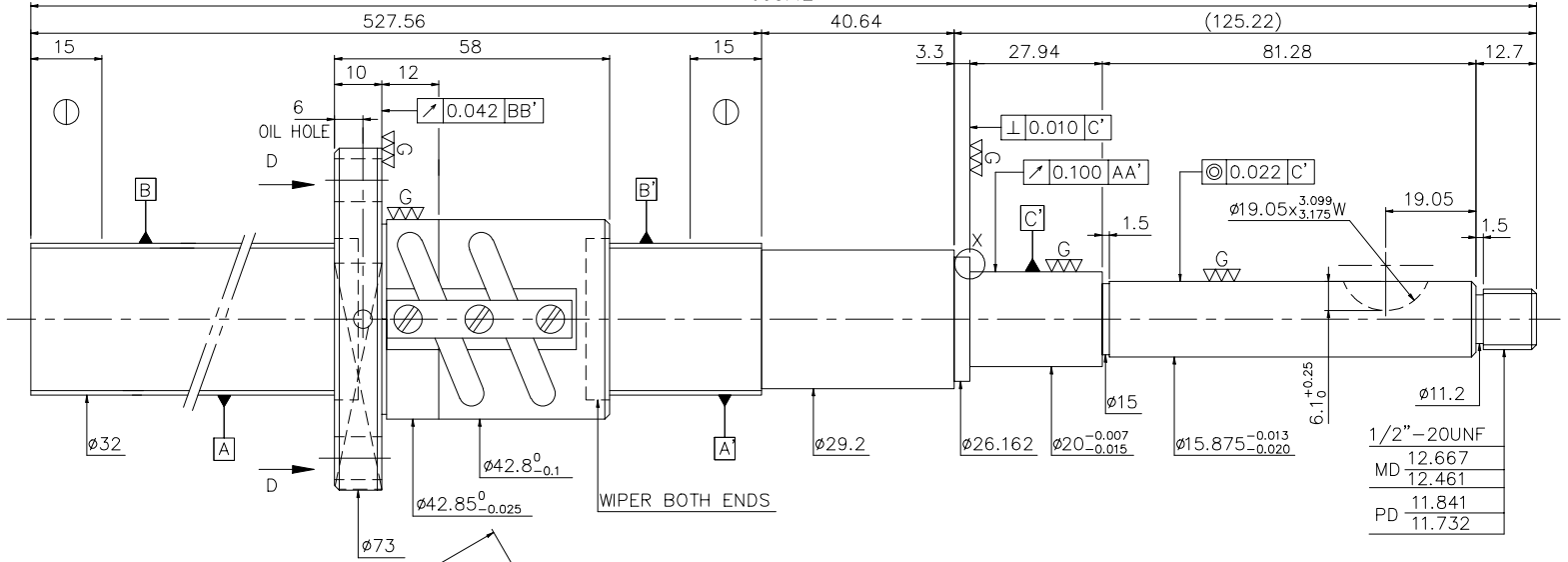

	1/2" - 20 UNF
MD	12.667
	12.461
PD	11.841
	11.732

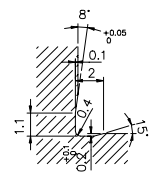
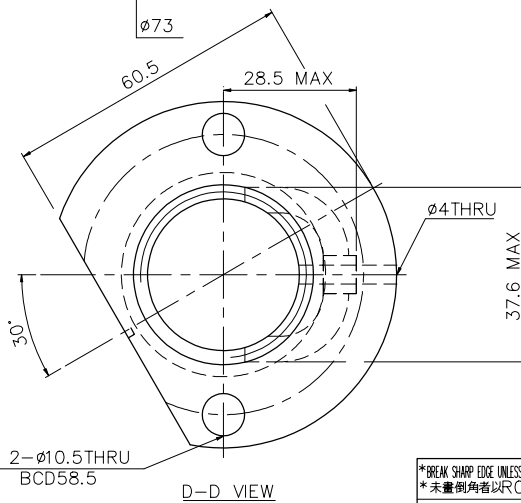

F0.4X0.2DIN509  
X DETAIL

1. MAX AXIAL LOAD: \_\_\_\_\_ kgf
2. MAX BALLSCREW ROTATIONAL SPEED: \_\_\_\_\_ rpm
- DN VALUE: \_\_\_\_\_
- ACCELERATION = \_\_\_\_\_ m/sec<sup>2</sup>
3. MAX FEED RATE: \_\_\_\_\_ m/min

PRELOAD(kgF)	113
R.D	29.124
S.F (kgf)	0.04~1.36
DRAG TORQUE(kgF-cm)	0.10~4.00
LUBRICATION	
DIRECTION OF TURN	L.H
PC DIA.	32.4
BALL DIA.	3.175
BACKLASH	0
CIRCUIT	2.5*2
LEAD ANGLE	2.86°
DYNAMIC (kgf)	1702
STATIC (kgf)	5098
LEAD	5.08

SPEC: L32-5.08B2-FSV-527.56-693.42-0.05

UNCHAMFERED USE	<input type="checkbox"/> R0.5	<input type="checkbox"/> R1	<input type="checkbox"/> R	SCALE	DATE							
ROUGH	M/FIN	M/C	GRD	1: X	11.29.'01							
UP	6	30	120	300	600	1200	2400	2400	MATERIAL	SH: CF53	DWG	张耀馨
10	±0.1	±0.2	±0.3	±0.4	±0.5	±0.8	±1.0	±1.5	THREAD BALL TRACK	APPD	G	F
									HRC	56 ~ 62	PROCESS NO.	
									CUSTOMER	HIWIN STD.		
									DWG.NO.	A10JSDA1		

DATE	MODIFICATION	APPROVED

\* PLEASE IGNORE CHINESE CHARACTERS WHICH ARE FOR OUR REFERENCE ONLY.

\*BREAK SHARP EDGE UNLESS OTHER SPECIFIED  
\*未畫倒角者以R0.5MAX

CUSTOMER DRAWING NO.

MC TYPE

AXIAL TYPE

E 300: 0.05

