

A10P4YA4

More Confidential

$\sqrt{Ra6.3}$  ( $\sqrt{Ra0.4}$ )

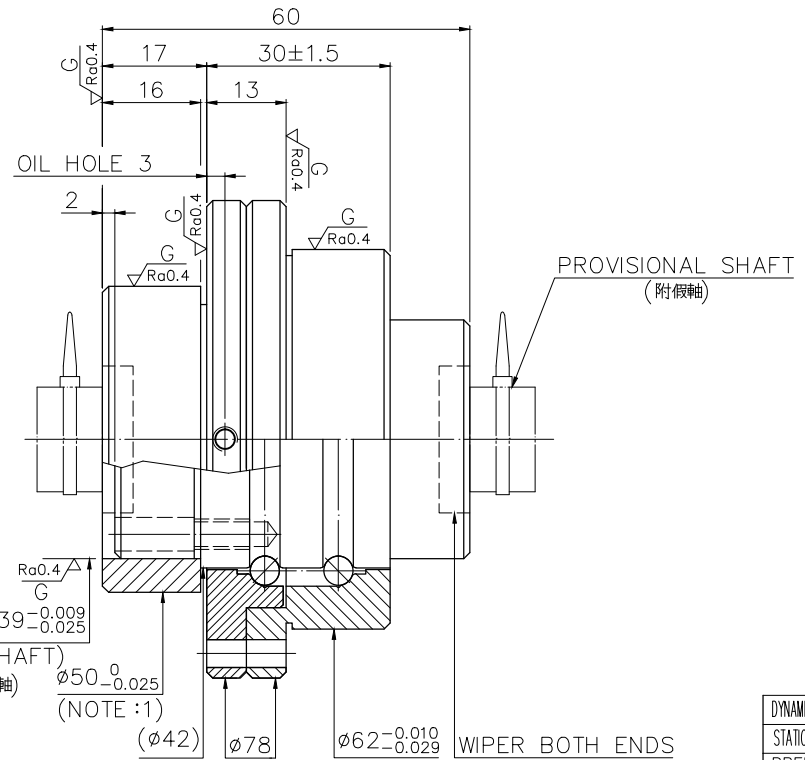
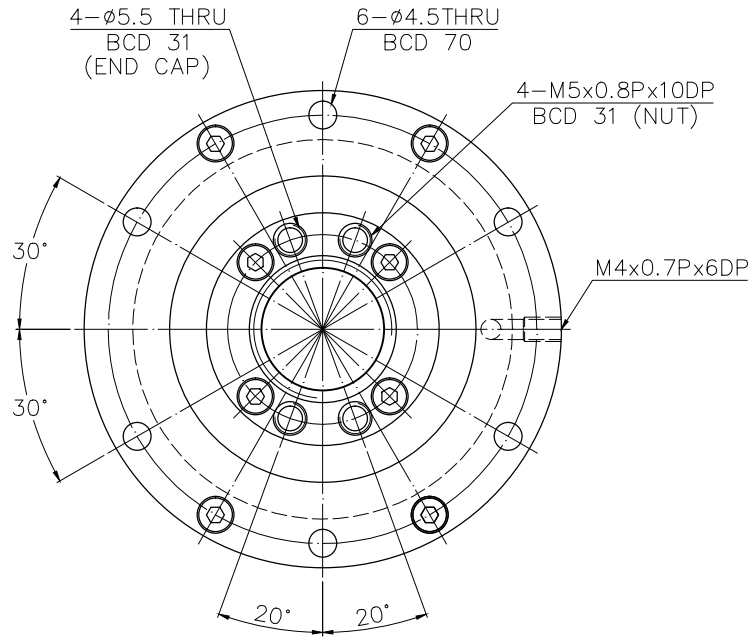

$\phi 39^{+0.025}_0 / \phi 39^{-0.009}_{-0.025}$   
(HOLE/SHAFT)  
(孔 / 軸)  
NOTE: 1)

SPEC: 4R20-20S2-DFSHR1

MAX. AXIAL LOAD (kgf)	LUBRICATION	BALL DIA.	1762
MAX. ROTATIONAL SPEED (rpm)	SPACE BALL	STATIC (BEARING) (kgf)	2531
DN VALUE	EI TYPE ASSEMBLY METHOD	PRELOAD (kgf)	~
MAX. FEED RATE (m/min)	CUSTOMER DRAWING NO.	R.D.	~
ACCELERATION (m/sec <sup>2</sup> )	CUSTOMER MC TYPE	S.F. (kgf)	~
SUPPORT METHOD	CUSTOMER AXIAL TYPE	DRAG TORQUE (kgf-cm)	~
		DIRECTION OF TURN	R
		P.C. DIA.	20.36
		BACKLASH	△ 0.04 MAX
		CIRCUIT	1.8*2
		LEAD ANGLE	17.36
		DYNAMIC (kgf)	796
		STATIC (kgf)	1740
		LEAD/PITCH	20/10

NOTE: 1. WITH COLLAR. (附擋塊)  
2. STEEL BALL TOLERANCE MUST BE IN THE RANGE OF -0.0025, -0.01.  
(鋼珠公差限用 -0.0025, -0.01.)

THREAD LENGTH	UNCHAMFERED USE <input type="checkbox"/> CO.5 <input checked="" type="checkbox"/> C1 <input type="checkbox"/> C	SH:ROLLED	DATE	2019.06.20
$\frac{+}{0}$	ROUGH M/C FIN M/C GRD	NT:SNCM220/Equivalent	DWG	Sandy
$\frac{-}{0}$	$\sqrt{Ra25}$ $\sqrt{Ra6.3}$ $\sqrt{Ra0.4}$	SCALE	CHK	Sting
$\frac{+}{0}$	NORMAL TOLERANCE mm	1: X	APPD	Michelle
$\frac{-}{0}$	UP 6 150 120 300 600 1200 2400 OVER	THREAD BALL TRACK		
$\frac{-}{0}$	±0.1 ±0.2 ±0.3 ±0.4 ±0.5 ±0.8 ±1.0 ±1.5	HRC 56 ~ 62		
$\frac{-}{0}$	$\frac{+}{0}$	CUSTR	H-CHICAGO	
$\frac{-}{0}$	$\frac{-}{0}$	DWG.NO.	A10P4YA4	

\*BREAK SHARP EDGE UNLESS OTHER SPECIFIED.  
\*未畫倒角者去毛邊 (CO.2 MAX)

● THREAD END ALLOWS ABOVE LENGTH OUT OF HARDNESS TOLERANCE

2019.06.20	MOD.	Michelle
DATE	MODIFICATION	APPROVED

\* PLEASE IGNORE CHINESE CHARACTERS WHICH ARE FOR OUR REFERENCE ONLY.

HIWIN® BALLSCREWS