

1
A10P50A1

2
Released by HIWIN design group.

3
4
5
6
7
8
9
G
▽ (▽▽)

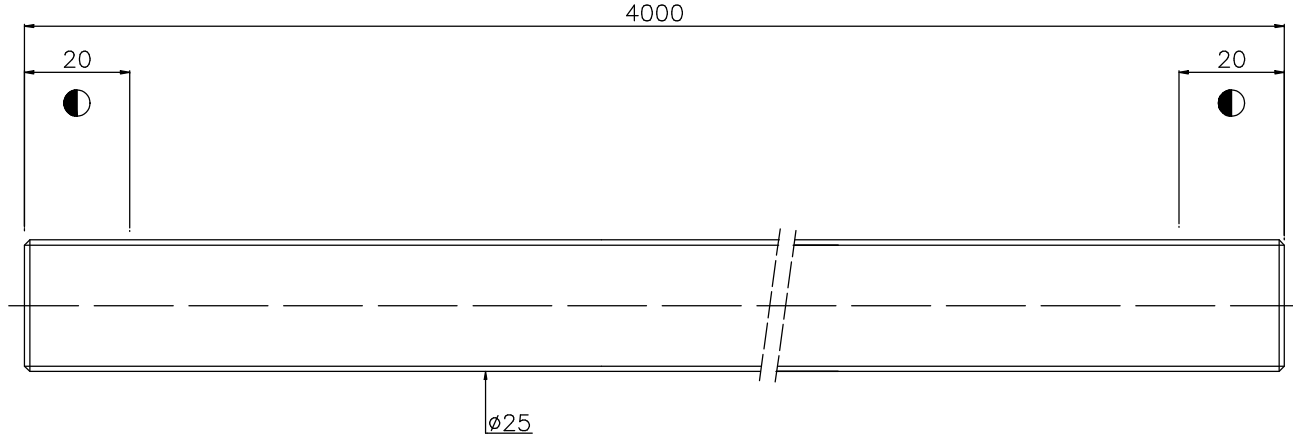

SPEC: R25-5.08-4000-4000-0.05

MAX. AXIAL LOAD (kgf)	LUBRICATION	PRELOAD (kgf)	~
MAX. ROTATIONAL SPEED (rpm)	SPACE BALL	R.D	22.924
DN VALUE	EI TYPE ASSEMBLY METHOD	S.F (kgf)	~
MAX. FEED RATE (m/min)	CUSTOMER DRAWING NO.	DRAG TORQUE (kgf-cm)	~
ACCELERATION (m/sec ²)	CUSTOMER MC TYPE	DIRECTION OF TURN	R
SUPPORT METHOD	CUSTOMER AXIAL TYPE	PC DIA.	25.57
		BALL DIA.	3.175
		BACKLASH	~
		CIRCUIT	~
		LEAD ANGLE	3.62
		DYNAMIC (kgf)	~
		STATIC (kgf)	~
		LEAD	5.08

UNCHAMFERED USE <input type="checkbox"/> R0.5 <input checked="" type="checkbox"/> R1 <input type="checkbox"/> R	SCALE	1: X
ROUGH M/C 25 _y FIN M/C 6.3 _o GRD 0.4 _t (▽▽)	MATERIAL	SH: CF53 DATE 2003.04.09
UNTOL DIMN mm	THREAD BALL TRACK	APPD
UP TO 6 30 120 300 600 1200 2400	HRC 56 ~ 62	PROCESS NO. G
±0.1 ±0.2 ±0.3 ±0.4 ±0.5 ±0.8 ±1.0 ±1.5	CUSTOMER	HIWIN STD.
	DWG.NO.	A10P50A1

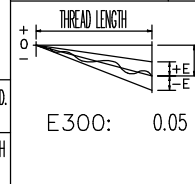

*BREAK SHARP EDGE UNLESS OTHER SPECIFIED.
*??????R0.5MAX
THREAD END ALLOWS ABOVE LENGTH OUT OF HARDNESS TOLERANCE

DATE	MODIFICATION	APPROVED

* PLEASE IGNORE CHINESE CHARACTERS WHICH ARE FOR OUR REFERENCE ONLY.

HIWIN BALLSCREWS