

1
A10P57A1

2
Released by HIWIN design group.

3
4
5
6
7
8
9
▽ (▽^G▽)

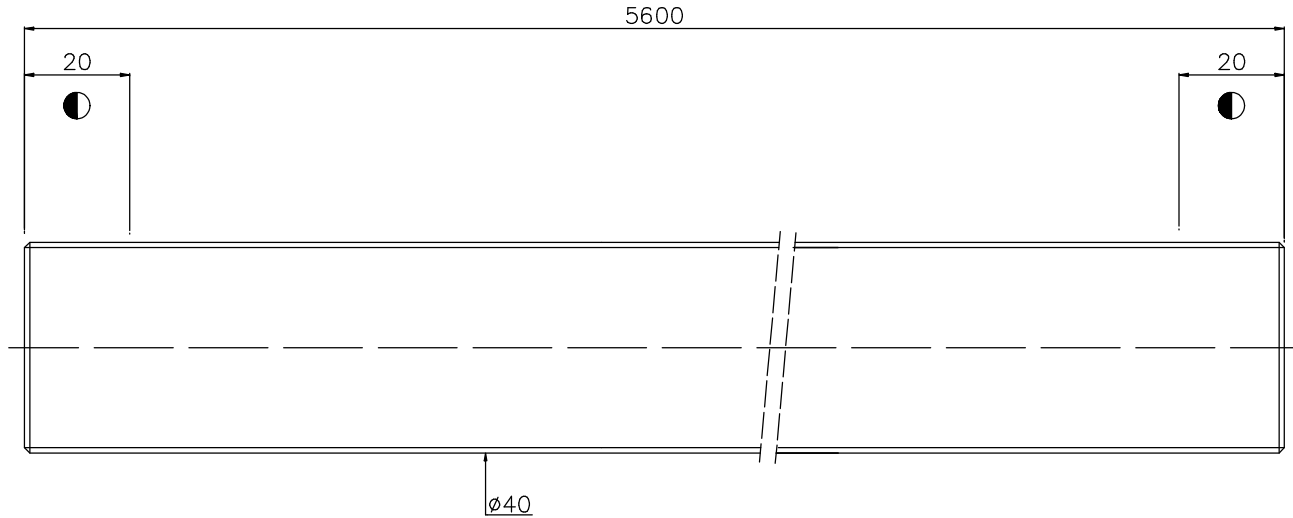

SPEC: 2R40-12.7-5600-5600-0.05

PRELOAD (kgf)	~
R.D	36.427
S.F (kgf)	~
DRAG TORQUE (kgf-cm)	~
DIRECTION OF TURN	R
PC DIA.	40.483
BALL DIA.	3.969
BACKLASH	~
CIRCUIT	~
LEAD ANGLE	5.70
DYNAMIC (kgf)	~
STATIC (kgf)	~
LEAD / PITCH	12.7 / 6.35

MAX. AXIAL LOAD (kgf)	LUBRICATION	SPACE BALL
MAX. ROTATIONAL SPEED (rpm)	EI TYPE ASSEMBLY METHOD	CIRCUIT
DN VALUE	CUSTOMER DRAWING NO.	LEAD ANGLE
MAX. FEED RATE (m/min)	CUSTOMER MC TYPE	DYNAMIC (kgf)
ACCELERATION (m/sec ²)	CUSTOMER AXIAL TYPE	STATIC (kgf)
SUPPORT METHOD		LEAD / PITCH

	UNCHAMFERED USE <input type="checkbox"/> R0.5 <input checked="" type="checkbox"/> R1 <input type="checkbox"/> R SCALE 1: X MATAL SH: CF53 DATE 2003.04.09 NT: SNCM220 DWG ??? THREAD BALL TRACK APPD HRC 56 ~ 62 PROCESS NO. G CUSTR HIWIN STD. DWG.NO. A10P57A1
--	---

*BREAK SHARP EDGE UNLESS OTHER SPECIFIED.
 *??????R0.5MAX
 THREAD END ALLOWS ABOVE LENGTH
 OUT OF HARDNESS TOLERANCE

DATE	MODIFICATION	APPROVED

* PLEASE IGNORE CHINESE CHARACTERS WHICH ARE FOR OUR REFERENCE ONLY.

HIWIN BALLSCREWS