

A114ABA5

More Confidential

$\sqrt{Ra6.3}$ ($\sqrt{Ra0.4}$)

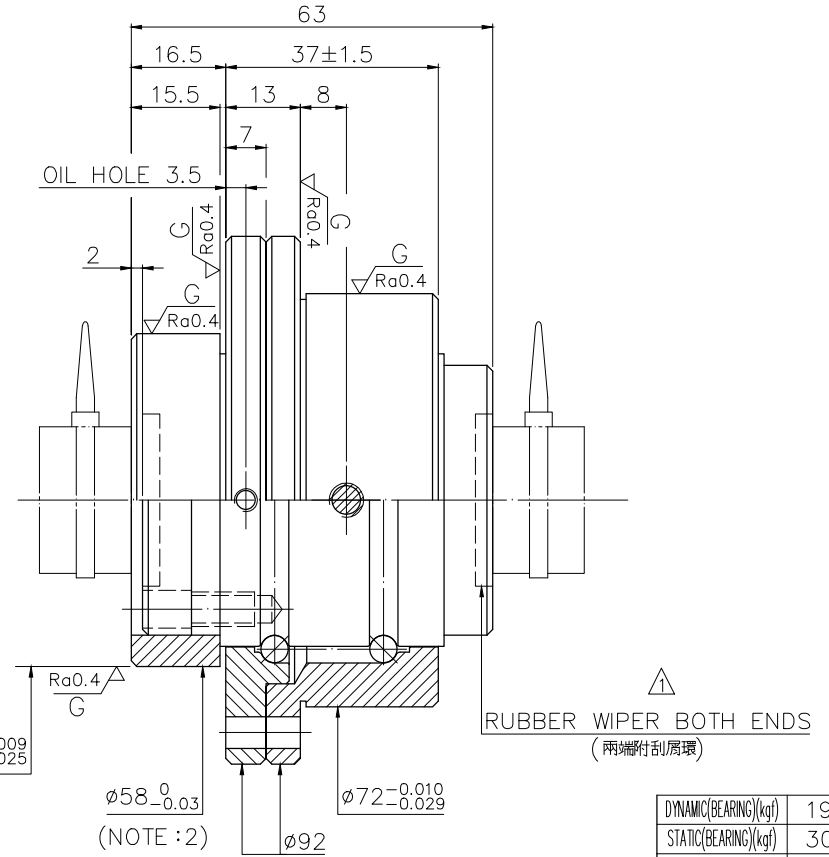
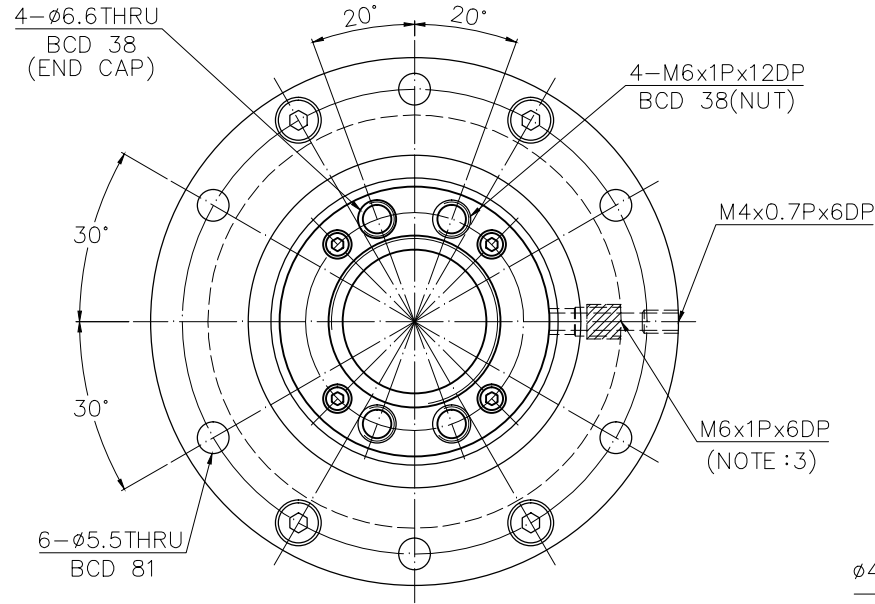

NOTE : 1. STEEL BALL TOLERANCE MUST BE IN THE RANGE OF $-0.0025, -0.015$.
 (鋼珠公差限用 $-0.0025, -0.015$.)
 2. WITH COLLAR. (附擋塊.)
 3. WITH PLUG. (附油塞.)

DYNAMIC BEARING(kgf)	1946
STATIC BEARING(kgf)	3036
PRELOAD(kgf)	~
R.D.	~
S.F. (kgf)	~
DRAG TORQUE(kgf-cm)	~
DIRECTION OF TURN	R
P.C. DIA.	26.03
BALL DIA.	3.969
BACKLASH	0.04MAX
CIRCUIT	1.8*2
LEAD ANGLE	17
DYNAMIC (kgf)	1300
STATIC (kgf)	3600
LEAD/PITCH	25/12.5

SPEC: 4R25-25S2-DFSHR1NW

MAX. AXIAL LOAD(kgf)	LUBRICATION	BALL DIA.	3.969
MAX. ROTATIONAL SPEED (rpm)	SPACE BALL	BACKLASH	0.04MAX
DN VALUE	EI TYPE ASSEMBLY METHOD	CIRCUIT	1.8*2
MAX. FEED RATE(m/min)	CUSTOMER DRAWING NO.	LEAD ANGLE	17
ACCELERATION (m/sec ²)	CUSTOMER MC TYPE	DYNAMIC (kgf)	1300
SUPPORT METHOD	CUSTOMER AXIAL TYPE	STATIC (kgf)	3600
		LEAD/PITCH	25/12.5

UNCHAMFERED USE	<input type="checkbox"/> C0.5 <input checked="" type="checkbox"/> C1 <input type="checkbox"/> C	SCALE	1: X	MAT.	SH-ROLLED	DATE	2019.06.20
ROUGH M/C FIN M/C I GRD	<input type="checkbox"/> <input type="checkbox"/> <input type="checkbox"/> <input type="checkbox"/>	SCALE	1: X	INT:	SNCM220/Equivalent	DWG	Sandy
$\sqrt{Ra25}$	$\sqrt{Ra6.3}$ $\sqrt{Ra0.4}$	NORMAL TOLERANCE mm		THREAD BALL TRACK	CHK	Shower	
UP TO	6 30 120 300 600 1200 2400	±0.1 ±0.2 ±0.3 ±0.4 ±0.5 ±0.8 ±1.0 ±1.5		HRC	56 ~ 62	APPD	Michelle
				CUSTR	H-CHICAGO		
				DWG.NO.	A114ABA5		

*BREAK SHARP EDGE UNLESS OTHER SPECIFIED.
 *未量倒角者去毛邊 (CO.2MAX)
 THREAD END ALLOWS ABOVE LENGTH OUT OF HARDNESS TOLERANCE.

2019.06.20	MOD.	Michelle
DATE	MODIFICATION	APPROVED

* PLEASE IGNORE CHINESE CHARACTERS WHICH ARE FOR OUR REFERENCE ONLY.

HIWIN BALLSCREWS