

A
B
C
D
E
F
G

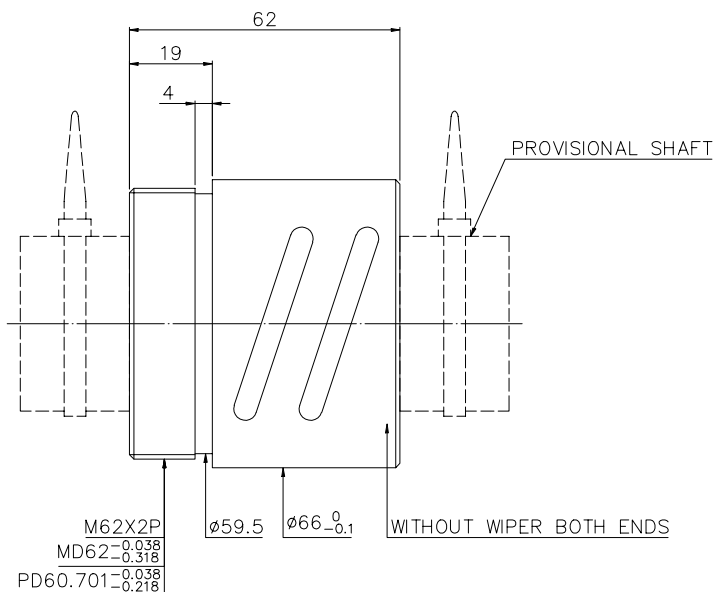
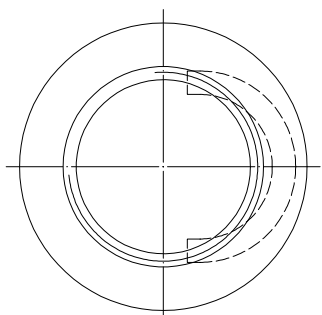

\triangle
NOTE: 1. Steel ball tolerance must be in the range of $-0.0025, -0.015$

SPEC: R40-5B2-RSB

MAX. AXIAL LOAD (kgf)	LUBRICATION	BALL DIA.	3.175
MAX. ROTATIONAL SPEED (rpm)	SPACE BALL	BACKLASH \triangle	0.03MAX
DN VALUE	EI TYPE ASSEMBLY METHOD	CIRCUIT	2.5*2
MAX. FEED RATE (m/min)	CUSTOMER DRAWING NO.	LEAD ANGLE	2.28
ACCELERATION (m/sec ²)	CUSTOMER M/C TYPE	DYNAMIC (kgf)	1859
SUPPORT METHOD	CUSTOMER AXIAL TYPE	STATIC (kgf)	6354
		LEAD	5

PRELOAD (kgf)	~
R.D	~
S.F (kgf)	~
DRAG TORQUE (kg-cm)	~
DIRECTION OF TURN	R
PC DIA.	40.03

UNCHAMFERED USE	<input type="checkbox"/> R0.5	<input checked="" type="checkbox"/> R1	<input type="checkbox"/> R	MATL	SH: ROLLED	DATE	2007.08.27
ROUGH M/C FIN M/C	250 Y	6.30 YZ	0.40 YZ	SCALE	INT: SNCM220/SCM415	DWG	KAI
UNTOL DIMN mm	UP 6 30 120 300 600 1200 2400 2400	±0.1 ±0.2 ±0.3 ±0.4 ±0.5 ±0.8 ±1.0 ±1.5	OVER	THREAD BALL TRACK	APPD	Lady	
				HRC	56 ~ 62	PROCESS NO.	G
				CUSTR	H-CHICAGO		
				DWG.NO.	A115NDA4		

*BREAK SHARP EDGE UNLESS OTHER SPECIFIED.
*未畫倒角者以R0.5MAX
● THREAD END ALLOWS ABOVE LENGTH OUT OF HARDNESS TOLERANCE

08.27.07	MOD. \triangle ~ \triangle	Lady
DATE	MODIFICATION	APPROVED

* PLEASE IGNORE CHINESE CHARACTERS WHICH ARE FOR OUR REFERENCE ONLY.

