

1
A11JTJA1

2
Released by HIWIN design group.

3
4
5
6
7
8
9
▽ (▽▽) ^G

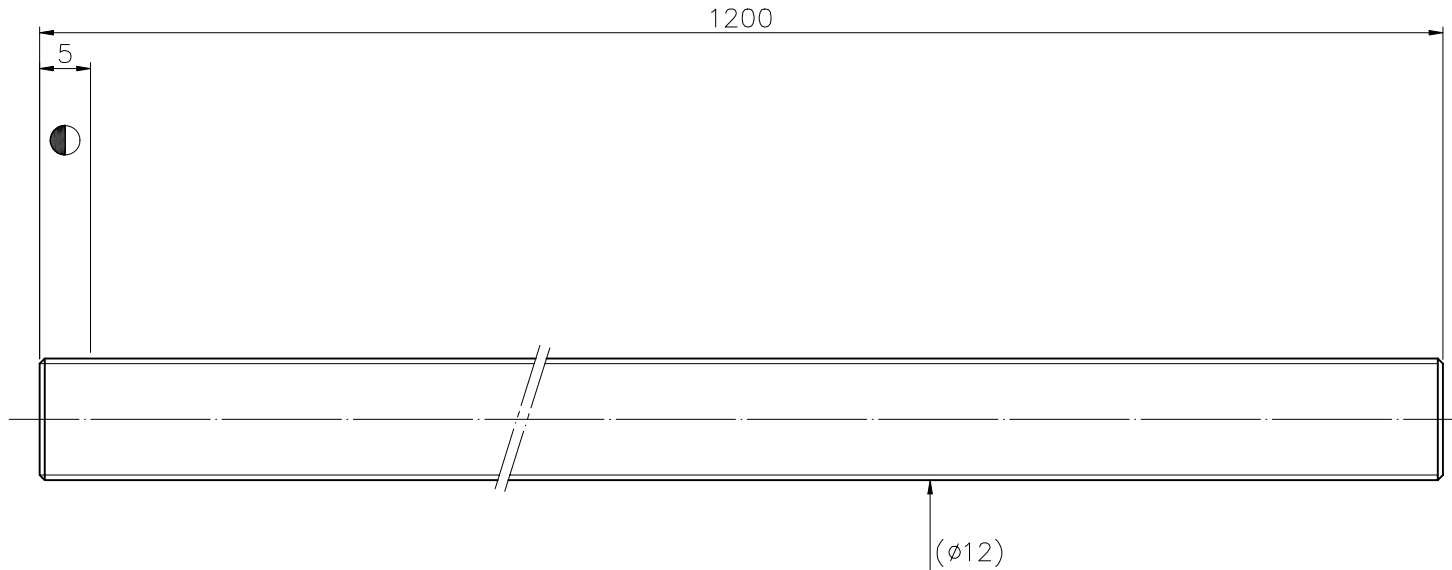

PRELOAD(kgf)	~
R.D.	10.236
S.F. (kgf)	~
DRAG TORQUE(kgf-cm)	~
DIRECTION OF TURN	R
P.C. DIA.	12.3

SPEC:2R12-5.08-1200-1200-0.05

MAX. AXIAL LOAD (kgf)	LUBRICATION	BALL DIA.
MAX. ROTATIONAL SPEED (rpm)	SPACE BALL	BACKLASH
DN VALUE	E1 TYPE ASSEMBLY METHOD	CIRCUIT
MAX. FEED RATE (m/min)	CUSTOMER DRAWING NO.	LEAD ANGLE
ACCELERATION (m/sec ²)	CUSTOMER MC TYPE	DYNAMIC (kgf)
SUPPORT METHOD	CUSTOMER AXIAL TYPE	STATIC (kgf)
		LEAD/PITCH

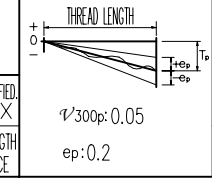

*BREAK SHARP EDGE UNLESS OTHER SPECIFIED.
*未畫倒角者以R0.5MAX
● THREAD END ALLOWS ABOVE LENGTH OUT OF HARDNESS TOLERANCE

UNCHAMFERED USE	<input checked="" type="checkbox"/> R0.5	<input type="checkbox"/> R1	<input type="checkbox"/> R
ROUGH M/C	25a	FIN M/C	6.3a
GRD	0.4g	SCALE	1: X
▽	▽▽		
NORMAL TOLERANCE mm			
UP	6	30	120
TO	30	120	300
	120	300	600
	600	1200	2400
	2400	2400	OVER
	±0.1	±0.2	±0.3
	±0.4	±0.5	±0.8
	±1.0	±1.5	

MAT.	SH: CF53/Equivalent	DATE	2009.09.25
THREAD BALL TRACK	HRC 56 ~ 62	DWG	Green
APPD	Cody	PROCESS NO.	G
CUSTR	HIWIN STD.		
DWG.NO.	A11JTJA1		

DATE	MODIFICATION	APPROVED

* PLEASE IGNORE CHINESE CHARACTERS WHICH ARE FOR OUR REFERENCE ONLY.

HIWIN® BALLSCREWS