

A1AA2UA3

More Confidential

$\sqrt{Ra6.3}$ ($\sqrt{Ra0.4}$)

A
B
C
D
E
F
G

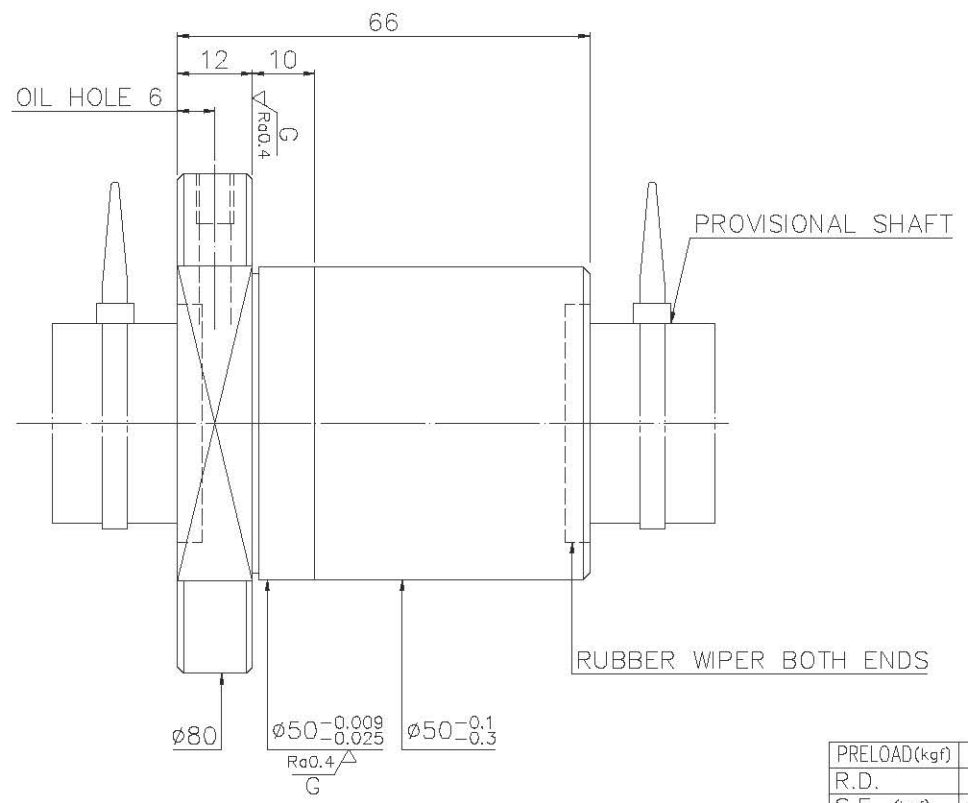
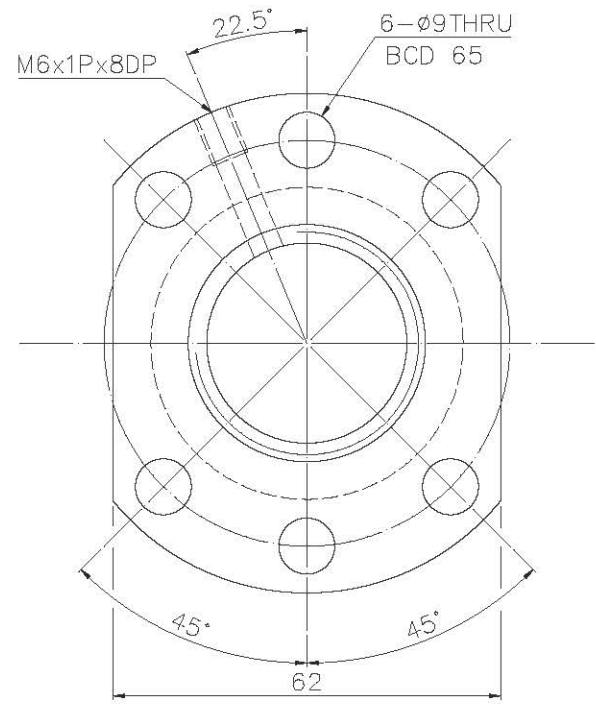

PRELOAD(kgf)	~
R.D.	~
S.F. (kgf)	~
DRAG TORQUE(kgf-cm)	~
DIRECTION OF TURN	R
P.C. DIA.	32.4
BALL DIA.	3.175
BACKLASH	0.03MAX
CIRCUIT	6
LEAD ANGLE	2.81
DYNAMIC (kgf)	1830
STATIC (kgf)	5545
LEAD	5

△
SPEC: R32-5T6-FSIFW

MAX. AXIAL LOAD(kgf)	LUBRICATION	BALL DIA.	3.175
MAX. ROTATIONAL SPEED (rpm)	SPACE BALL	BACKLASH	0.03MAX
DN VALUE	E1 TYPE ASSEMBLY METHOD	CIRCUIT	6
MAX. FEED RATE(m/min)	CUSTOMER DRAWING NO.	LEAD ANGLE	2.81
ACCELERATION (m/sec ²)	CUSTOMER MC TYPE	DYNAMIC (kgf)	1830
SUPPORT METHOD	CUSTOMER AXIAL TYPE	STATIC (kgf)	5545
		LEAD	5

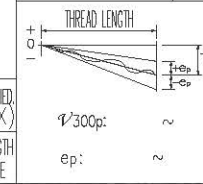

*BREAK SHARP EDGE UNLESS OTHER SPECIFIED.
*未畫倒角者去毛邊 (CO.2MAX)
● THREAD END ALLOWS ABOVE LENGTH OUT OF HARDNESS TOLERANCE

UNCHAMFERED USE	<input type="checkbox"/> C0.5	<input type="checkbox"/> C1	<input type="checkbox"/> C						
ROUGH M/C/FIN	M/C/I	GRD	SCALE						
$\sqrt{Ra25}$	$\sqrt{Ra6.3}$	$\sqrt{Ra0.4}$	1: X						
NORMAL TOLERANCE mm									
UP	6	30	120	300	600	1200	2400	2400	OVER
TO	±0.1	±0.2	±0.3	±0.4	±0.5	±0.8	±1.0	±1.5	

MAT.	SH-ROLLED	DATE	2018.05.18
	INT: S55C/Equivalent	DWG	Yolin
THREAD BALL TRACK	CHK	Shower	
HRC 56 ~ 62	APPD	Kelly	
CUSTR	H-CHICAGO		
DWG.NO.	A1AA2UA3		

2018.05.18	MOD. /	Kelly
DATE	MODIFICATION	APPROVED

* PLEASE IGNORE CHINESE CHARACTERS WHICH ARE FOR OUR REFERENCE ONLY

HIWIN BALLSCREWS